

DESIGNED AND DIMENSIONED  
IN MILLIMETERS [INCHES]

ERM5-XXX-XX.X-X-DV-XX-TR

DO NOT  
SCALE FROM  
THIS PRINT

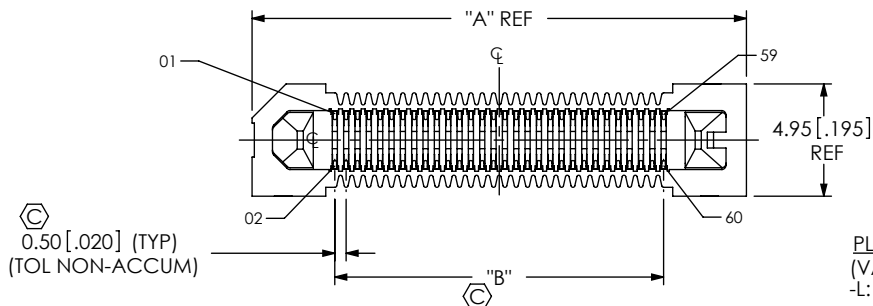

No OF POSITIONS  
(PER ROW)  
-005, -010, -020,  
-030, -040, -050,  
-060, -070, -075

LEAD STYLE  
-02.0 = 2MM  
-04.0 = 4MM  
-05.0 = 5MM

PLATING SPECIFICATION  
(VALUES GIVEN ARE IN MICRO-INCHES)

-L: LIGHT SELECTIVE,  
10 Au / 50 Ni MIN ON CONTACT,  
MATTE TIN TAIL  
-S: SELECTIVE, 30 Au / 50 Ni MIN ON CONTACT,  
MATTE TIN TAIL

PACKAGING  
-TR: TAPE & REEL  
(SEE NOTES 5 & 6)

OPTIONS  
-K: POLYIMIDE FILM PAD (SEE NOTE 6)  
-FL: FRICTION LOCK (NOT AVAILABLE  
WITH -WT, ONLY AVAILABLE UP TO  
30 POSITIONS)  
(FOR MATING WITH ERF5-XXX-XX.X-X-DV-FL)  
-WT: WELD TAB (NOT AVAILABLE  
WITH -FL)  
(FOR MATING WITH ERF5-XXX-XX.X-X-DV-WT)  
-P: PICK AND PLACE PAD  
(ONLY AVAILABLE WITH -020 THRU -075 POSITIONS)

ROW SPECIFICATION  
-DV: DOUBLE VERTICAL

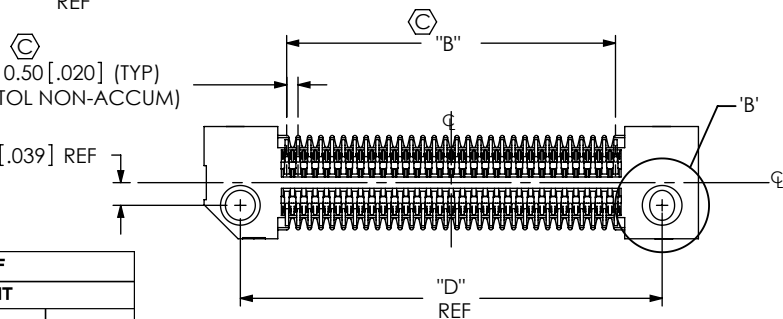
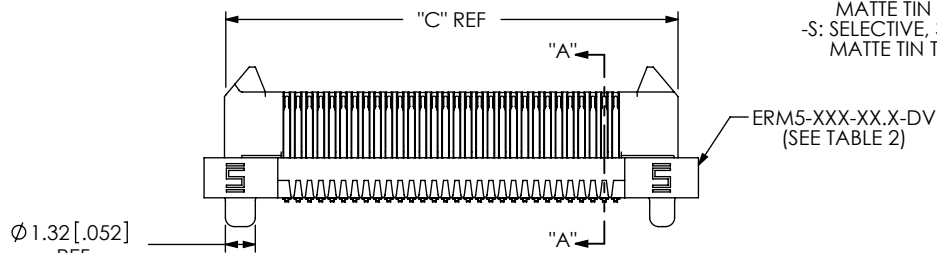
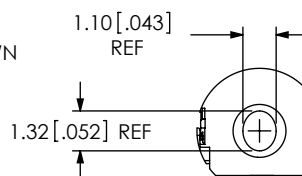
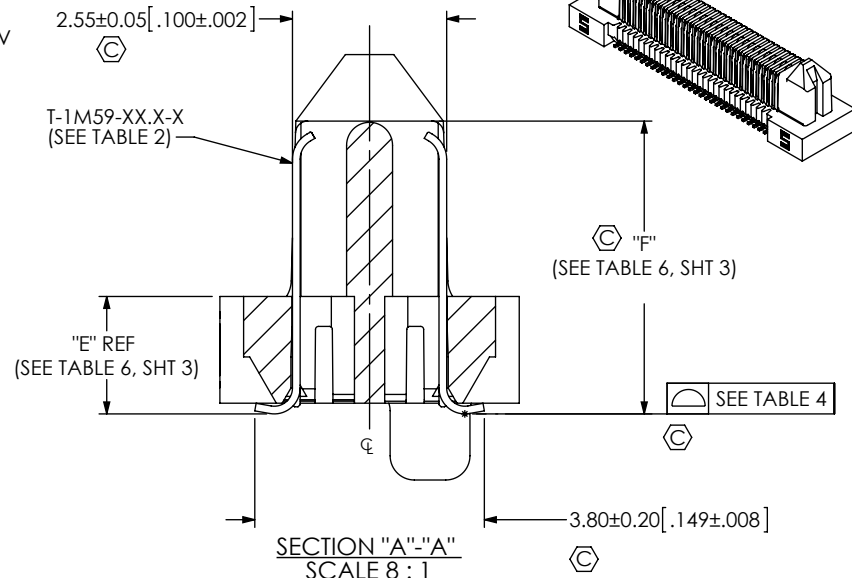

FIG 1  
ERM5-030-02.0-X-DV-XX SHOWN



DETAIL 'B'  
SCALE 4 : 1



NOTES:

1. Ⓢ REPRESENTS A CRITICAL DIMENSION.
2. MAXIMUM BURR ALLOWANCE: 0.038[.0015]
3. MINIMUM PUSHOUT FORCE: 1.6 N [4 LB.]  
MINIMUM WELD TAB PUSHOUT FORCE,  
-04.0 & -05.0 LEAD STYLES: 2.25 N [.5 LB.]  
-02.0 LEAD STYLE: 1.45 N [.3 LB.]
4. DELETED
5. FOR QUANTITIES UP TO 49 PIECES, NO LEADER,  
TRAILER, OR REEL WILL BE SUPPLIED. FOR QUANTITIES  
50-124, NO LEADER OR TRAILER WILL BE SUPPLIED.
6. LEAD STYLE -02.0 WITH -K-TR OPTIONS AVAILABLE TO EXISTING CUSTOMERS ONLY.

TABLE 1 REF STACK HEIGHT		
ERM5 LEAD STYLE	ERF5 LEAD STYLE	
	-05.0	-07.0
-02.0	7.0MM	9MM
-05.0	10.0MM	12MM
-04.0	9.0MM	11MM

TABLE 2		
LEAD STYLE	ERM5-XXX-XX.X-DV	T-1M59-XX.X-X
-02.0	ERM5-XXX-02.0-DV	T-1M59-02.0-X
-05.0	ERM5-XXX-05.0-DV	T-1M59-05.0-X
-04.0	ERM5-XXX-04.0-DV	T-1M59-04.0-X

TABLE 3				
POSITION	"A"	"B"	"C"	"D"
-005	9.30 [0.366]	2.00 [0.079]	7.50 [0.295]	6.10 [0.240]
-010	11.80 [0.465]	4.50 [0.177]	10.00 [0.394]	8.60 [0.339]
-020	16.80 [0.661]	9.50 [0.374]	15.00 [0.591]	13.60 [0.535]
-030	21.80 [0.858]	14.50 [0.571]	20.00 [0.787]	18.60 [0.732]
-040	26.80 [1.055]	19.50 [0.768]	25.00 [0.984]	23.60 [0.929]
-050	31.80 [1.252]	24.50 [0.965]	30.00 [1.181]	28.60 [1.126]
-060	36.80 [1.449]	29.50 [1.161]	35.00 [1.378]	33.60 [1.323]
-070	41.80 [1.646]	34.50 [1.358]	40.00 [1.575]	38.60 [1.520]
-075	44.30 [1.744]	37.00 [1.457]	42.50 [1.673]	41.10 [1.618]

TABLE 4	
No. OF POS.	
-010, -020, -030, -040	0.10 [0.004]
-050, -060, -070, 075	0.13 [0.005]

UNLESS OTHERWISE SPECIFIED,  
DIMENSIONS ARE IN  
MILLIMETERS [INCHES].  
TOLERANCES ARE:  
DECIMALS ANGLES  
X.X: ±0.3 [0.1]  
X.XX: ±0.13 [0.005]  
X.XXX: ±0.050 [0.0020]

PROPRIETARY NOTE  
THIS DOCUMENT CONTAINS CONFIDENTIAL AND  
PROPRIETARY INFORMATION AND ALL DESIGN,  
MANUFACTURING, REPRODUCTION, USE, PATENT RIGHTS  
AND SALES RIGHTS ARE EXPRESSLY RESERVED BY SAMTEC,  
INC. THIS DOCUMENT SHALL NOT BE DISCLOSED, IN WHOLE  
OR PART, TO ANY UNAUTHORIZED PERSON OR ENTITY NOR  
REPRODUCED, TRANSFERRED OR INCORPORATED IN ANY  
OTHER PROJECT IN ANY MANNER WITHOUT THE EXPRESS  
WRITTEN CONSENT OF SAMTEC, INC.



520 PARK EAST BLVD. NEW ALBANY, IN 47150  
PHONE: 812-944-6733 FAX: 812-948-5047  
e-Mail: info@SAMTEC.com code 55322

MATERIAL: DO NOT SCALE DRAWING  
INSULATOR: LCP, COLOR: BLACK  
TERMINAL: BeCu OR PHOS BRONZE

SHEET SCALE: 3:1

DESCRIPTION:  
.5MM EDGE RATE TERMINAL ASSEMBLY

DWG. NO.  
ERM5-XXX-XX.X-X-DV-XX-TR

BY: DAVID W 4/30/2008 SHEET 1 OF 3

IN PROCESS 1  
CUT T-1M59-XX.X-X TERMINAL COMBS  
(ALL TAILS SAME DIRECTION)

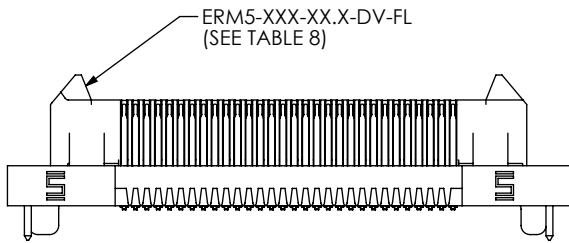
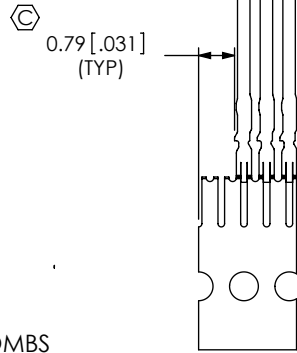
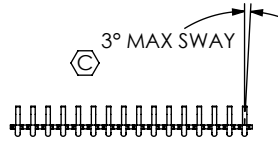

FIG 4  
(ERM5-030-02.0-X-DV-WT SHOWN)  
(SAME AS FIG 3)  
(NOT AVAILABLE WITH -FL)

LEAD STYLE	ERM5-XXX-XX.X-DV-XX	WT-36-XX-T
-02.0	ERM5-XXX-02.0-DV-FL	WT-36-05-T
-05.0	ERM5-XXX-05.0-DV-FL	WT-36-01-T
-04.0	ERM5-XXX-04.0-DV-FL	WT-36-06-T

POSITION	"J"	"K"	"L"	"M"
-005	12.30 [0.484]	10.50 [0.413]	9.10 [0.358]	8.50 [0.335]
-010	14.80 [0.583]	13.00 [0.512]	11.60 [0.457]	11.50 [0.453]
-020	19.80 [0.780]	18.00 [0.709]	16.60 [0.654]	16.00 [0.630]
-030	24.80 [0.976]	23.00 [0.906]	21.60 [0.850]	21.00 [0.827]
-040	29.80 [1.173]	28.00 [1.102]	26.60 [1.047]	26.00 [1.024]
-050	34.80 [1.370]	33.00 [1.299]	31.60 [1.244]	31.00 [1.220]
-060	39.80 [1.567]	38.00 [1.496]	36.60 [1.441]	36.00 [1.417]
-070	44.80 [1.764]	43.00 [1.693]	41.60 [1.638]	41.00 [1.614]
-075	47.30 [1.862]	45.50 [1.791]	44.10 [1.736]	43.50 [1.713]

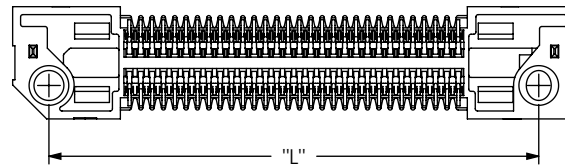
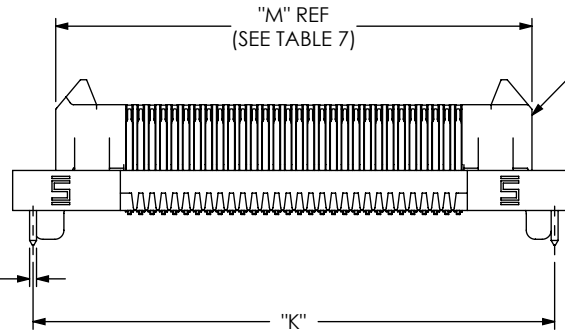
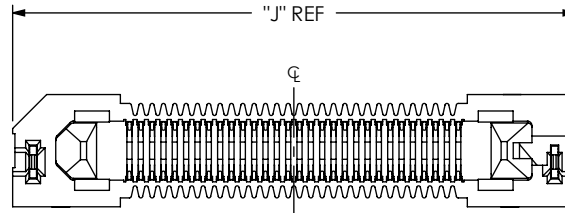
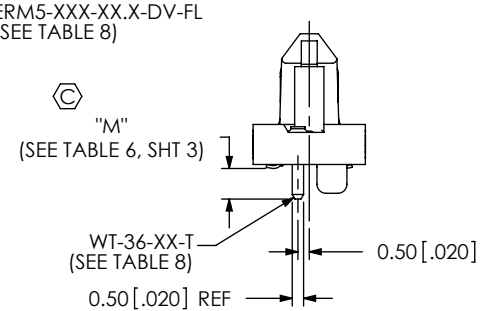

FIG 3  
(ERM5-030-02.0-X-DV-FL SHOWN)  
(SAME AS FIG 1 EXCEPT AS SHOWN)  
(NOT AVAILABLE WITH -WT, ONLY AVAILABLE UP TO 30 POSITIONS)



**PROPRIETARY NOTE**  
THIS DOCUMENT CONTAINS CONFIDENTIAL AND PROPRIETARY INFORMATION AND ALL DESIGN, MANUFACTURING, REPRODUCTION, USE, PATENT RIGHTS AND SALES RIGHTS ARE EXPRESSLY RESERVED BY SAMTEC, INC. THIS DOCUMENT SHALL NOT BE DISCLOSED, IN WHOLE OR PART, TO ANY UNAUTHORIZED PERSON OR ENTITY NOR REPRODUCED, TRANSFERRED OR INCORPORATED IN ANY OTHER PROJECT IN ANY MANNER WITHOUT THE EXPRESS WRITTEN CONSENT OF SAMTEC, INC.

DO NOT SCALE DRAWING  
SHEET SCALE: 3:1



520 PARK EAST BLVD, NEW ALBANY, IN 47150  
PHONE: 812-944-6733 FAX: 812-948-5047  
e-Mail info@SAMTEC.com code 55322

DESCRIPTION:  
.5MM EDGE RATE TERMINAL ASSEMBLY  
DWG. NO.  
**ERM5-XXX-XX.X-X-DV-XX-TR**  
BY: DAVID W 4/30/2008 SHEET 2 OF 3

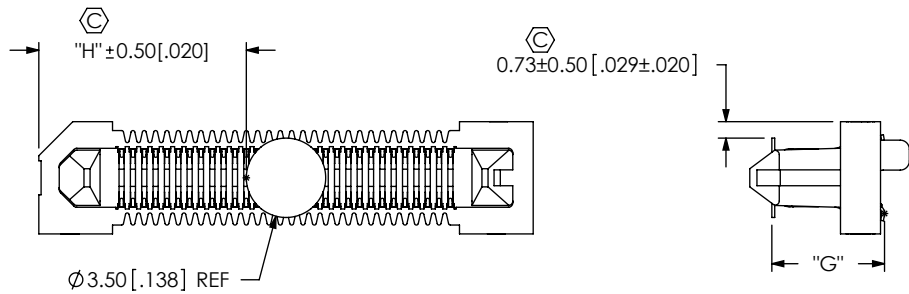

FIG 2  
-K OPTION  
(USE K-DOT-138-250-005)  
(ERM5-030-02.0-X-DV-K SHOWN)

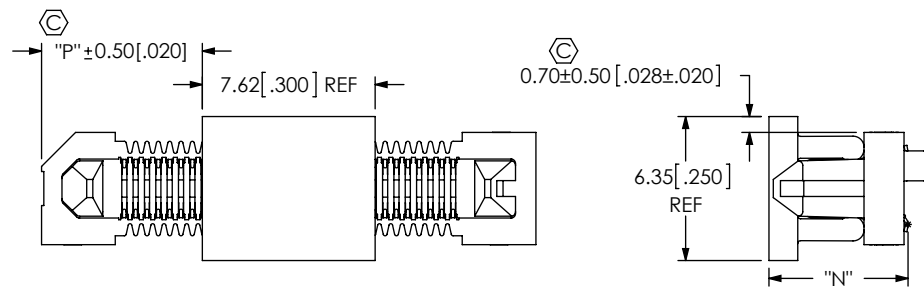

FIG 5  
-P OPTION  
(USE PPP-08)  
(ERM5-030-02.0-X-DV-P SHOWN)

TABLE 5

POSITION	"H"			"P"		
	-K	-K-WT	-K-FL	-P	-P-WT	-P-FL
-005	2.90 [0.114]	4.40 [0.173]	4.40 [0.173]	-	-	-
-010	4.15 [0.163]	5.65 [0.222]	5.65 [0.222]	-	-	-
-020	6.65 [0.262]	8.15 [0.321]	8.15 [0.321]	4.59 [0.181]	6.09 [0.240]	6.09 [0.240]
-030	9.15 [0.360]	10.65 [0.419]	10.65 [0.419]	7.09 [0.279]	8.59 [0.338]	8.59 [0.338]
-040	11.65 [0.459]	13.15 [0.518]	-	9.59 [0.378]	11.09 [0.437]	-
-050	14.15 [0.557]	15.65 [0.616]	-	12.09 [0.476]	13.59 [0.535]	-
-060	16.65 [0.656]	18.15 [0.715]	-	14.59 [0.574]	16.09 [0.633]	-
-070	19.15 [0.754]	20.65 [0.813]	-	17.09 [0.673]	18.59 [0.732]	-
-075	20.40 [0.803]	21.90 [0.862]	-	18.34 [0.722]	19.84 [0.781]	-

TABLE 6

LEAD STYLE	"E"	"F"	"G"	"M"	"N"
-02.0	1.94 [0.076]	4.84 [0.191]	4.97 [0.196]	1.35 [0.053]	6.11 [0.241]
-05.0	4.94 [0.194]	7.84 [0.309]	7.97 [0.314]	1.40 [0.055]	9.11 [0.359]
-04.0	3.94 [0.155]	6.84 [0.269]	6.97 [0.274]	1.12 [0.044]	8.11 [0.319]

PROPRIETARY NOTE

THIS DOCUMENT CONTAINS CONFIDENTIAL AND PROPRIETARY INFORMATION AND ALL DESIGN, MANUFACTURING, REPRODUCTION, USE, PATENT RIGHTS AND SALES RIGHTS ARE EXPRESSLY RESERVED BY SAMTEC, INC. THIS DOCUMENT SHALL NOT BE DISCLOSED, IN WHOLE OR PART, TO ANY UNAUTHORIZED PERSON OR ENTITY NOR REPRODUCED, TRANSFERRED OR INCORPORATED IN ANY OTHER PROJECT IN ANY MANNER WITHOUT THE EXPRESS WRITTEN CONSENT OF SAMTEC, INC.

DO NOT SCALE DRAWING

SHEET SCALE: 3:1



520 PARK EAST BLVD, NEW ALBANY, IN 47150  
PHONE: 812-944-6733 FAX: 812-948-5047  
e-Mail info@SAMTEC.com code 55322

DESCRIPTION:  
.5MM EDGE RATE TERMINAL ASSEMBLY

DWG. NO.  
ERM5-XXX-XX.X-X-DV-XX-TR

BY: DAVID W 4/30/2008 SHEET 3 OF 3